

# St Brides

Three bedroom terrace with parking space

ground floor

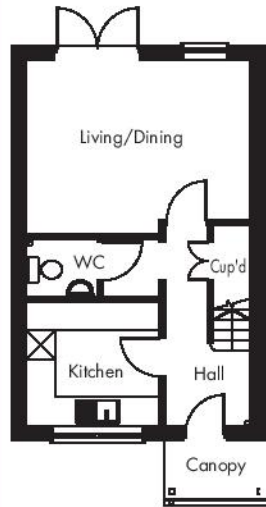

first floor

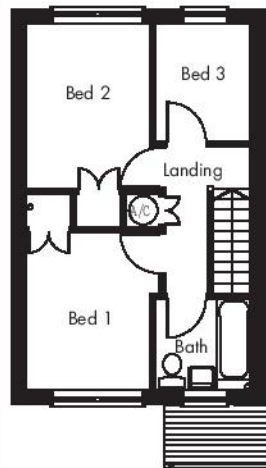

	<i>Metric</i>	<i>Imperial</i>		<i>Metric</i>	<i>Imperial</i>
<b>GROUND FLOOR</b>			<b>FIRST FLOOR</b>		
Living Room	4.714m x 3.650m	15'6" x 12'0"	Bedroom 1	2.600m x 3.300m	8'7" x 10'10"
Kitchen	2.800m x 2.600m	9'3" x 8'7"	Bedroom 2	2.600m x 3.464m	8'7" x 11'5"
Cloaks	1.072m x 1.200m	3'6" x 4'0"	Bedroom 3	2.000m x 2.462m	6'7" x 8'1"
WC	1.500m x 1.200m	4'11" x 3'11"	Bathroom	2.000m x 1.900m	6'7" x 6'3"
Hall	3.900m x 1.900m	12'10" x 6'3"	Landing	3.100m x 1.900m	10'3" x 6'3"