

# Newgale

Three bedroom detached with single garage

ground floor

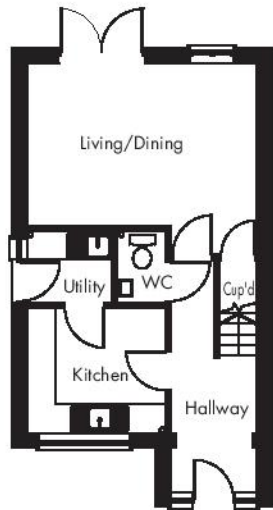

first floor

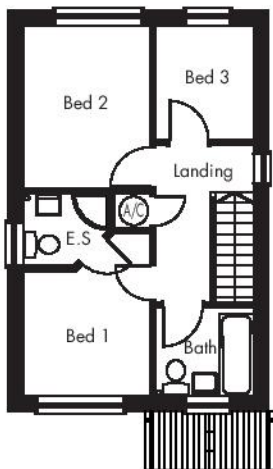

	<i>Metric</i>	<i>Imperial</i>		<i>Metric</i>	<i>Imperial</i>
<b>GROUND FLOOR</b>			<b>FIRST FLOOR</b>		
Living Room	4.800m x 3.400m	15'9" x 11'2"	Bedroom 1 (inc en-suite)	4.214m x 2.600m	13'10" x 8'7"
Kitchen	2.772m x 2.600m	9'1" x 8'7"	Bedroom 2	2.636m x 3.400m	8'8" x 11'2"
Utility	1.672m x 1.500m	5'6" x 4'11"	Bedroom 3	2.050m x 2.386m	6'9" x 7'10"
WC	0.986m x 1.500m	3'3" x 4'11"	Bathroom	2.050m x 1.850m	6'9" x 6'1"
Hall	4.854m x 1.914m	15'11" x 6'4"	Landing	2.050m x 3.264m	6'9" x 10'9"

All dimensions are approximate and subject to change. For illustration purposes only. Some features may vary from those shown.